

Richard T. Flood, Jr. & Sally Elliot Flood Athletic Center

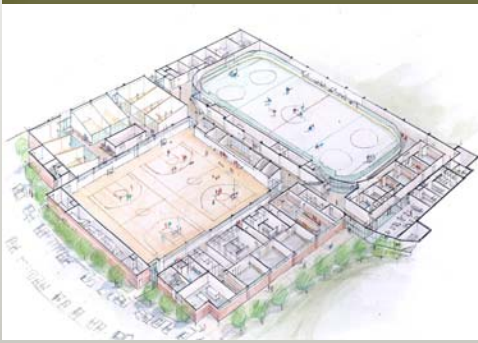

Project team

Owner: Salisbury School
 Architect: The Office of Michael Rosenfeld
 Mechanical: Cronis, Liston, Nangle, and White, LPP
 Electrical: Thompson Engineering Inc.
 Structural: Foley Buhl Roberts & Associates



Building Information

Address: Salisbury, CT
 Size: 106,386 ft²
 Levels: 2 levels
 Cost: \$28.5 million
 Construction Time: June 1st 2008 – December 15th 2009
 Delivery Method: Design-Bid-Build

Architectural Design

Located on the east side of campus that consists of ice rink, squash pavilion, basketball courts, wrestling room, trainers facilities.

Façade: glass, brick, and metal panels

Roofing: standing seam metal roof

Mechanical

(9) Air Handling Units, 87445 CFM total
 (4) Burner Units, (14) pumps, (21) fans, and (28) Water Heating Coils

Specialties: (1) Ice Rink Ventilating and Dehumidifying unit installed due to the function of the building

Electrical

Electric Supply: (8) 208Y/120 3 phase 4 wire panels at 10,000 amps. (3)

480Y/277 3 phase 4 wire panels at 25,000 amps. (1) 480Y/277 3 phase 4 wire panels at 14,000 amps.

Main Lighting Ballast : T5 Fluorescent

Lighting Mount: Pendant

Structural

Floor: 5" slab on grade

Exterior Wall: Brick Veneer, 8" Cold-formed stud wall

Roof: Versa-dek metal roof deck
 Truss to truss cross framing

Foundation: slab on grade foundation with footings

