



Whether it's day's first light or a lasting impression, light constantly changes our world.

Smr

LIGHTING ... CREATIVITY. ART. INSPIRATION. BELIEF. REFLECTION. IMPRESSION. BEAUTY. MASTERY. CUNNING. SUSTAINABILITY. IMAGINATION. VISION. BRILLIANCE. LUMINOUS. RADIANT. SHINE. CLEAR. ARCHITECTURE. DAYLIGHT. KNOWLEDGE. AGLOW. INTRIGUE. INNOVATION. DREAM. RADIANCE. BEAM. PROFESSIONAL. ELEGANCE. DEXTERITY. NATURE. STRATEGY CONCEPT. COMFORT. TEXTURE. PERSUASION. LIGHT. ORNAMENT. GUIDANCE. IGNITE. ENERGY. MAGNIFICENT. ENHANCE. SPACIOUS. HONESTY. POLISHED. IMAGE. MERGE. GLEAM. CURIOSITY. INTEGRITY. PASSIONATE LEARN. MOOD. STANCE. SUBTLETY. TRANSLUCENT. INTEREST. CHARACTER. DESIRE. TWIST. IMPACT. CONTRAST. EXPLORATION. GRACE. ATTITUDE. PERSONALITY. DESIGN. VALUE. AFFECTION. FULFILL. DIM. ESSENCE. DRAW. CHARISMA. FEEL. SECRET. FESTIVE. DRAFT. EXQUISITE. CONCEAL. INTERPRETATION. SHAPE. PURPOSE. STYLE. POSITION. APPROACH. SKETCH. HUE. STRUCTURE. VIEW. SPIRIT. FASHION. COMMUNICATION. VIVID. INTIMACY. APPEARANCE. LOVE. ACHIEVEMENT. CHANGE. DRAMATIC. PASSION. DIRECTION. WARMTH. RELAXATION. TRANSPARENT. REVEAL. ACCENT. DARK. INDIVIDUALITY. SYMBOLIC. BLEND. PUBLIC. HIGHLIGHT. INTRIGUE. ORGANIZATION. ADMIRATION. COLOR. RESPONSE. COMPILE. TRUTH. NURTURING. TARGET. SCHEME. BEAUTY. GAME. ENTHUSIASM. ORDER. SHADOW. TONE. SMOOTH. ATTRACTION. MERIT. FADED. PICTURESQUE. SOCIETY. POWER. PEACE. IMPRESSION. BALANCE. ACCOMPLISH. SEE. FINE. PERCEPTION. ENTICE. MEMORY. CONNECTION. EMOTION. ALLURE. EXPRESSION.

... DESIGN

Creating the essence of ...

Timelessness

Exterior Facade
Chandler City Hall

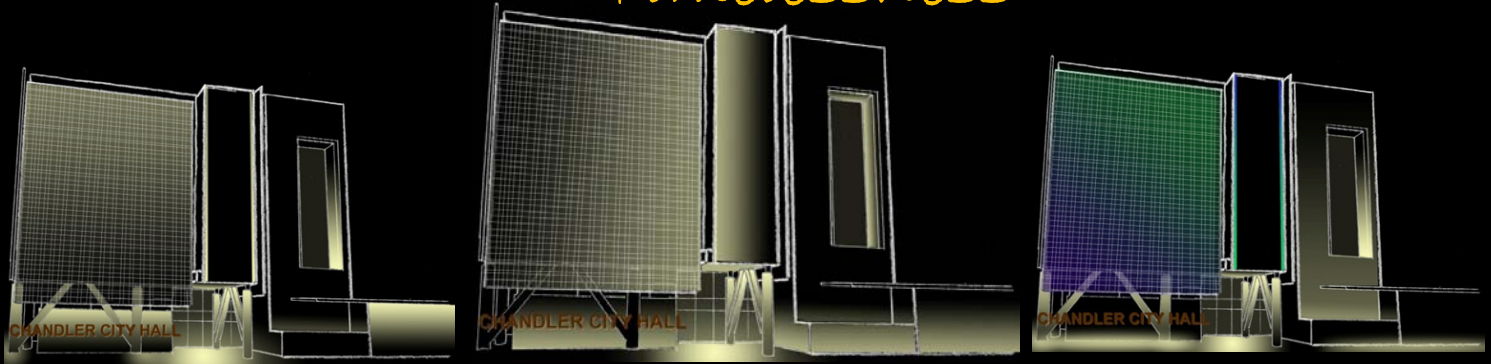

Architectural Engineering Senior Thesis

Creating the essence of ...

Lobby | Open Office | Council Chamber

Chandler City Hall

Timelessness

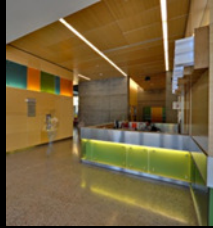

Creating the essence of ...

Timelessness

Exterior Facade
Chandler City Hall



Architectural Engineering Senior Thesis

Enhancing Architecture... Lighting the Way

TRANSPARENCY AND CONCEALMENT

THE HOWARD BRANDSTON STUDENT LIGHTING DESIGN EDUCATION GRANT
2010

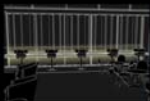

DOUBLE STORY CAFE
LOUNGE, L, 10.8 FC
COFFEE STATION, | 28.9 FC
ASHRAE 90.1
ALLOWABLE: 1618 W
ACTUAL: 1580 W

IN THE MEET OF AN URBAN LANDSCAPE, THE MODERN ARTS BUILDING PRESENTS ITSELF AS AN OUTSTANDING PIECE OF ART. THE TRANSLUCENT AND TRANSPARENT FACADE ALLOWS THE STREETSCAPE APPEAR AS A STAIRWELL, DRAWING THE EYES ACROSS THE ENTIRE LENGTH OF THE BUILDING. THE MODERN AND IDEAL LIGHTING DESIGN DOES THE SAME, ENHANCING THE PRESENCE OF THE BUILDING AS AN INVITING SPACE FOR STUDENTS, WHILE LURING PEOPLE FROM THE OUTSIDE INWARD. TRANSPARENCY AND CONCEALMENT OF THE SPACES ARE EMPHASIZED BY HOW LIGHT PLAYS WITH THE BUILDING MATERIALS, DRAWING ONE THROUGHOUT THE BUILDING. THE DOUBLE HEIGHT CAFE ON THE CORNER PROVIDES STUDENTS WITH AMPLE SUNLIGHT DURING THE DAYTIME, WHEREAS UPON NIGHTFALL, TRANSFORMS INTO A FUN AND EXCITING DINNERING SPACE. WITH EMPHASIS ON THE CEILING AND FOCAL POINTS AROUND THE PERIMETER, THE SPACE CREATES AN INVITING SENSATION FROM BOTH OUTSIDE AND WITHIN. SIMILARLY, THE VESTIBULE SPACE SERVES AS ANOTHER ALLURING ENTRY INTO THE BUILDING. POOLS OF LIGHT DRAW ONE INSIDE THE TRANSPARENT VESTIBULE, AND THE GLASS STAIRCASE CONCEALED CREATES A SENSE OF INTROSPE, GUIDING PEOPLE UPSTAIRS. THE LOBBY AND CIRCULATION SPACE NOT ONLY SERVE AS A LINK BETWEEN THESE TWO SPACES, BUT ALSO AN EXTENSION. ELLIPTICAL COVERS ACCENTUATE EACH COLUMN PROVIDING A RELATED LIGHTING SCHEME FOR A LINKING AREAL, WHILE ANOTHER COVER AROUND THE CORNER WALL CREATES AN AESTHETIC APPEAL. A MORE PURPOSEFUL LIGHT SERVES AS A GUIDING FORCE. IN THE OCCURRENCE OF A PERFORMANCE, THE TRICK FROM THE EVENT STAIRWELL IS TRANSFORMED INTO A DYNAMIC SPACE BY A THEATRICAL LIGHTING DESIGN.



LOBBY AND CIRCULATION
LOBBY, L, 13.2 FC
ASHRAE 90.1
ALLOWABLE: 3606 W
ACTUAL: 3470 W



USE OF GALL INTERFACE TO CREATE A THEATRICAL APPEAR DURING PERFORMANCES



GLASS VESTIBULE
VESTIBULE, L, 10.4 FC
ASHRAE 90.1
ALLOWABLE: 354 W
ACTUAL: 324 W



ENHANCING ARCHITECTURE... LIGHTING THE WAY

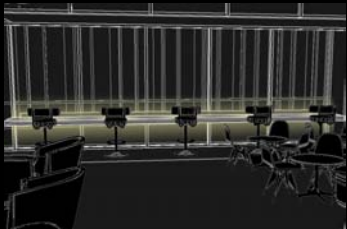
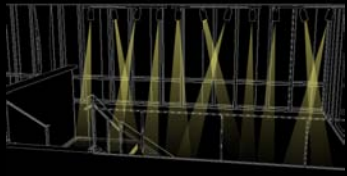
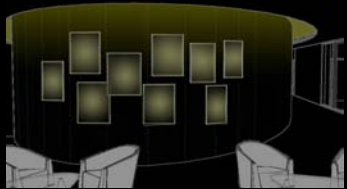
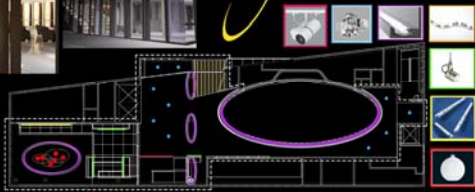

Enhancing Architecture... Lighting the Way

Drawing one from the outside in, the glow and the contrast create the focal points throughout, creating a path of transition within the space



Enhancing Architecture... Lighting the Way



Application and function relate the space to what's hidden beyond the normal realm of view



Warmth and relaxation provide a comfortable public space for gathering or studying as one pleases.



AGI 32 Sports Lighting Study

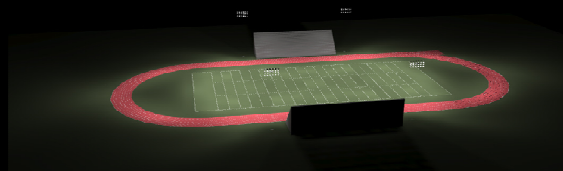
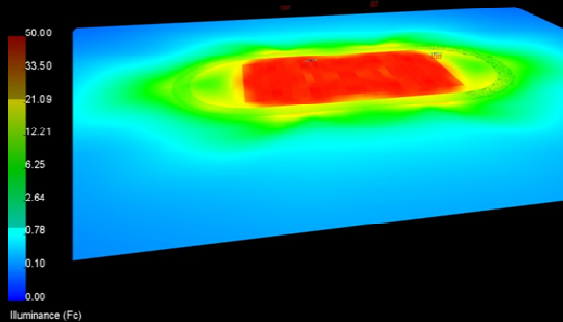

Revit Daylight Studies

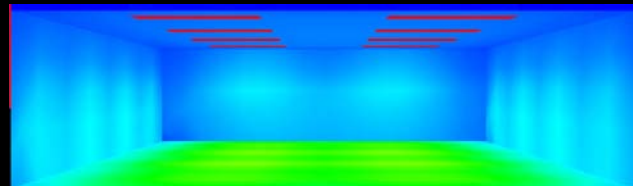
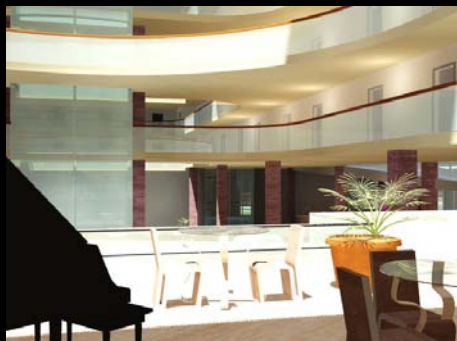

Skylight Study
Evaluation of Well Efficiency vs. Uniformity

AGI 32 Daylight Studies

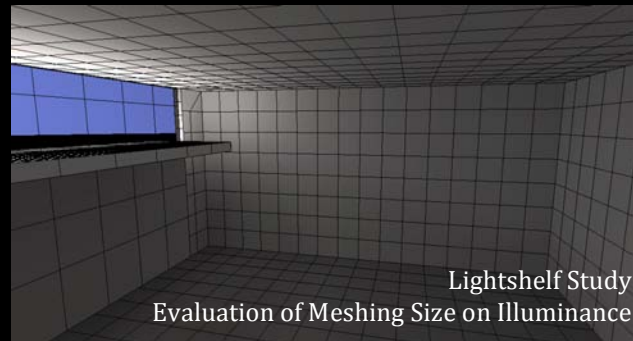

Lightshelf Study
Evaluation of Meshing Size on Illuminance

Daysim Blinds vs. Roller Shades Analysis

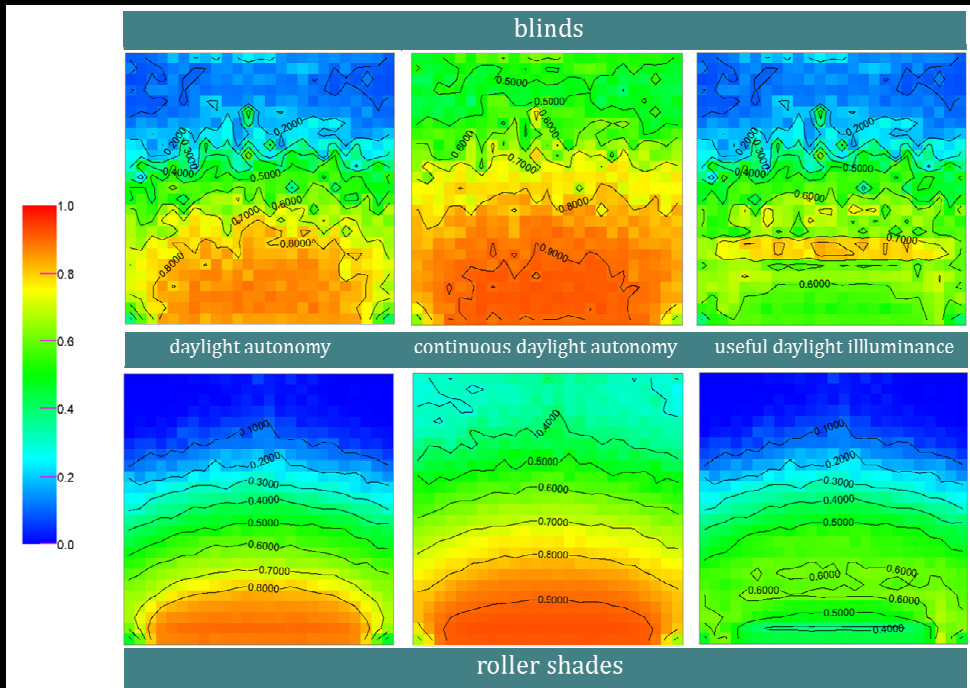



*It's not just what we see or where we are,
it's our emotion and perception
that changes the world
when everything falls into place.*

SMP



Ideas
&
Inspiration

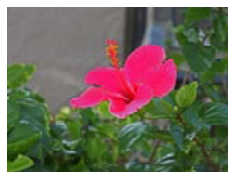
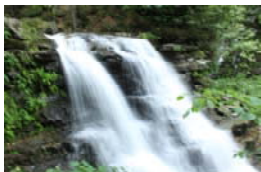
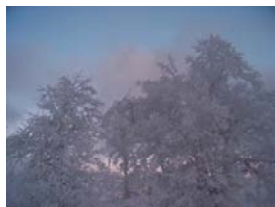

Concept Images

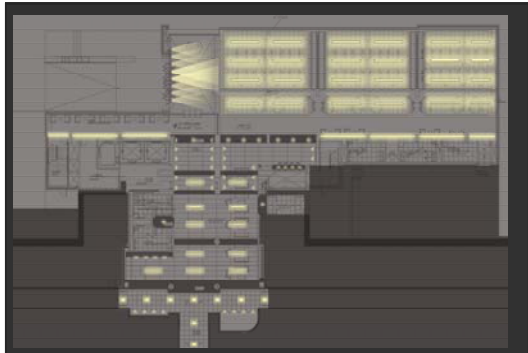
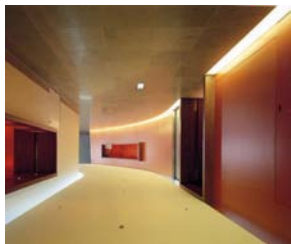

Horton Lees Brogden Lighting Design
SUNY Downstate Medical Center
Design Development



Concept to Design



Horton Lees Brogden Lighting Design
SUNY Downstate Medical Center
Design Development



Concept to Design

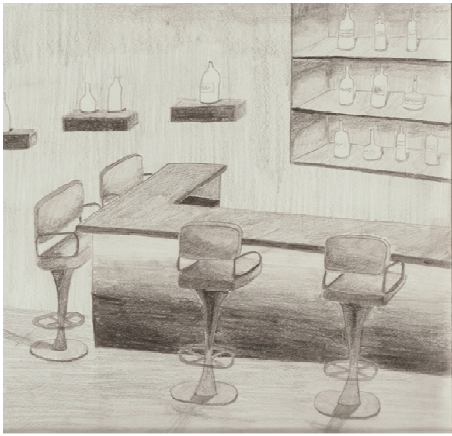

Flynn Impressions
Concept Sketches & Light Structure Model

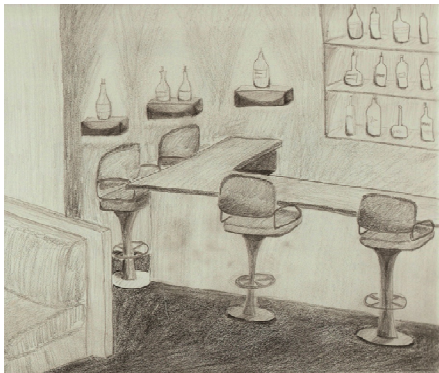
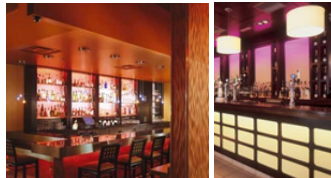

Festive and Somber



Eye-catching are the skylights that nearly cover the ceiling. This creates a calm sensation within the locale. The sunlight fulfills the ambient needs for individuals, while luminaires gently wash the perimeter walls. Adding to the relaxation, diffuse materials help to prevent unwanted glare and distractions.

Glass is the emphasis within this lobby. The towering glass wall allows the sun's light to spread throughout the room producing a comfortable atmosphere. In addition to this, the glass panels lining the stairway allow light to pass through, so as to create openness rather than enclosure.





Standing tall and mystifying the diffuse material of the cubed shelving draws one's attention to and through the structure. Furthermore, the careful combination of contrast and reflective properties allow the semi-specular components to grab hold of one's gaze as the light grazes a few select surfaces.

Featuring the bar display shelves, the light falls at such an angle that it reaches deep into the cube-like voids capturing one's interest. Additionally, hovering shadows fall discretely on the floor and bar face to create an intriguing combination of shadow and light.



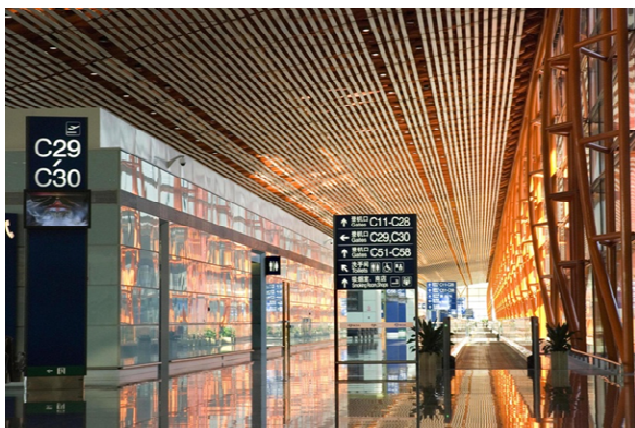

As the high luminance levels deep in the space create a focal point, the specular reflections in the immediate locale captivate those who draw near. This combination of techniques intrigues and lures individuals into and through the space, leading them to their final destination.

The light falling over the bookcase within this corner space creates a mode either public or private depending on the occasion. The quiet and calm tones of light give way to a relaxing mood, while the extension of reflections in the window may stimulate one's curiosity.





Accent lighting from beneath the plants combined with color correlated temperature of the lamps creates a warm mood. The lights then are positioned from the floor through the leaves to portray an image like that of light glistening off of water which establishes a dramatic backdrop.

Light falls from the ceiling capturing the three dimensional wall panels lining the back wall to create small shadows within the thin gaps. A warm atmosphere is produced in the sitting area which can be further enhanced by the lamp lighting to set the desired mood for the space.

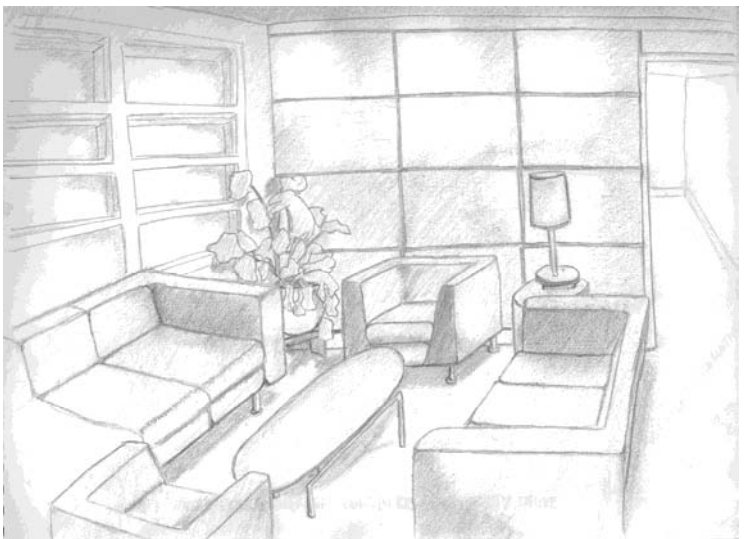

Education

The Pennsylvania State University
Architectural Engineering | Lighting/Electrical
B.A.E./M.A.E Candidate

E.I.T Upon Graduation

Experience

Lighting Design Intern

Horton Lees Brogden Lighting Design
New York, NY
May-August 2011

Lighting Design Intern

SmithGroup
Detroit, MI
May-August 2010

Engineering Intern

Powerhouse Design Architects and
Engineers Inc. (AE Works)
Pittsburgh, PA
May-August 2009,
December 2009 - January 2010

smr5094@psu.edu



Thank you.

Stephanie M. Romanias

Experience



*It's not just what we see or where we are,
 it's our emotion and perception
 that changes the world
 when everything falls into place.*

SMP