

THE URBN CENTER & URBN CENTER ANNEX PHILADELPHIA, PA



ARCHITECTURE:

- RENOVATION OF A ROBERT VENTURI DESIGN
- SLIDING WALLS ALLOW STUDENTS TO CREATIVLY CHANGE THEIR WORK SPACE
- CURTAIN WALLS ALONG EAST AND NORTH ELEVATIONS AND A ROOF SKYLIGHT ALLOW FOR PASSIVE SOLAR LIGHT

CONSTRUCTION:

- PHASED CONSTRUCTION:
URBN CENTER (PHASE A): (10/17/11) - (9/24/12)
ANNEX (PHASE B): (12/14/11) - (10/12/12)

MEP SYSTEM:

- MECHANICAL ROOMS LOCATED ON THE GROUND FLOOR
- CHILLED BEAMS ARE USED FOR COOLING AND HEATING
- LINEAR T-5 FLOURECENT DIRECT/INDERECT LIGHTING
- LUTRON QUANTUM LIGHT MANAGEMENT HUB CONTROLLER
- POWER DISTRIBUTED WITH OUTPUT OF 277/480 V SYSTEM

STRUCTURAL:

- COLD FORMED METAL FRAMING
- 8 LEVELS IN 4 STORIES WITH A MEZZANINE STAIR SYSTEM
- COMPOSITE SLAB (2 1/2" NORMAL WEIGHT CONC. 2" DECK)

BUILDING DETAILS:

OWNER: DREXEL UNIVERSITY

G.C: TURNER CONSTRUCTION

ARCHITECT: MS&R, LTD

CONTRACT TYPE: LUMP-SUM

SIZE: 145917 SF

STORIES: 4

TOTAL COST: \$31M

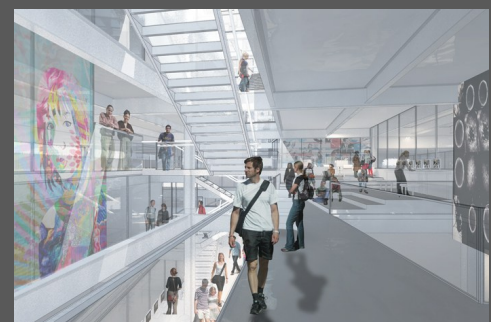

All renderings are property of MS&R LTD

GHAITH YACOUB | CONSTRUCTION MANAGEMENT OPTION

[HTTP://WWW.ENGR.PSU.EDU/AE/THESIS/PORTFOLIOS/2013/GXY903/INDEX.HTML](http://www.engr.psu.edu/ae/thesis/portfolios/2013/gxy903/index.html)



&

Turner

SPECIAL THANKS TO: