

Presentation Outline and Sample Slides

Thesis Progress Report
Bucks County Justice Center
Doylestown, PA

Joshua Lange

Lighting/Electrical

Thesis Adviser: Dr. Richard Mistrick

Electrical Adviser: Gary Golaszewski

3/30/2015

	Number of slides
1 Introduction	
1.1 Presentation Overview	1
1.2 Location/Site	1
1.3 Building Overview	1
2 Lighting Depth	
2.1 Main Lobby	
2.1.1 Introduction/Location	1
2.1.2 Design Criteria	1
2.1.3 Final Design	2
2.1.4 Design Analysis	2
2.2 Open Office	
2.2.1 Introduction/Location	1
2.2.2 Design Criteria	1
2.2.3 Final Design	2
2.2.4 Design Analysis	2
2.3 Ceremonial Courtroom	
2.3.1 Introduction/Location	1
2.3.2 Design Criteria	1
2.3.3 Final Design	2
2.3.4 Design Analysis	2
3 Electrical Depth	
3.1 Introduction	1
3.2 Short Circuit/Coordination Study	1
4 Mechanical Breadth (CHP Analysis)	
4.1 Data Sources	1
4.2 Analysis	1
4.3 Conclusion	1
5 Acoustical Breadth and MAE Depth	
5.1 Introduction	1
5.2 Acoustical Breadth (RT Analysis)	1
5.3 MAE Depth (Audio Amplification System Analysis)	
5.3.1 Introduction	1
5.3.2 Unamplified Speech Propagation	1
5.3.3 Amplified Speech Propagation	1
6 Conclusion	
6.1 Lighting Depth	1
6.2 Electrical Depth	1
6.3 Mechanical Depth	1
6.4 Acoustical Breadth and MAE Depth	1

Total Slides: 36

Introduction
 Lighting Depth
 Electrical Depth
 Mechanical Breadth
 Acoustical Breadth and MAE Depth
 Conclusion

Final Presentation

Bucks County Justice Center

Doylestown, PA

Joshua Lange
 Lighting/Electrical

Thesis Adviser: Dr. Richard Mistrick
 Electrical Adviser: Gary Golaszewski

4/15/2015



Introduction
 Lighting Depth
 Main Lobby
 Open Office
 Introduction/Location
 Design Criteria
 Final Design
 Design Analysis
 Ceremonial Courtroom
 Electrical Depth
 Mechanical Breadth
 Acoustical Breadth and MAE Depth
 Conclusion

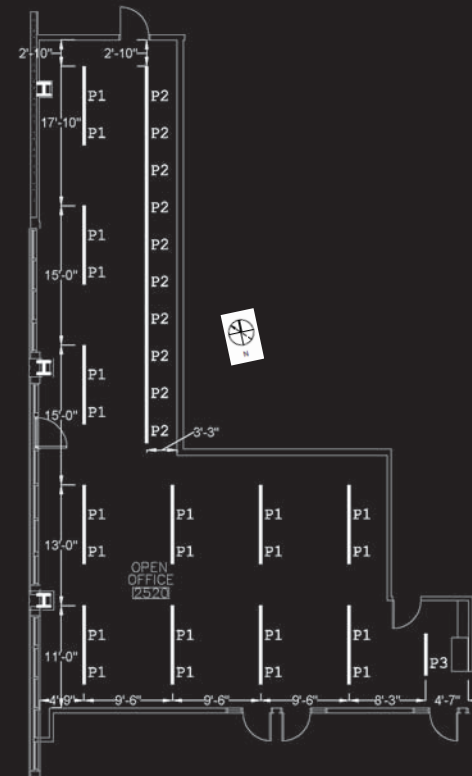

Type	Description	Manufacturer	Model	Lamp	Input Watts	Voltage	Fixture Image
P1	CYLINDRICAL LED DIRECT/INDIRECT PENDANT	PEERLESS	RD4M4 W20/20 8FT R8 277 EZB SCT LP835 F1/24 C110	INTEGRAL	40	277	
P1E	EMERGENCY CYLINDRICAL LED DIRECT/INDIRECT PENDANT	PEERLESS	RD4M4 W20/20 8FT R8 277 EZB 1 EC SCT LP835 F1/24 C110	INTEGRAL	40	277	
P2	CYLINDRICAL LED WALL WASHER PENDANT	PEERLESS	RD4MW W20 40FT R8 277 EZB SCT LP835 F1/24 C110	INTEGRAL	20	277	
P3	CYLINDRICAL LED DIRECT/INDIRECT PENDANT	PEERLESS	RD4M4 W40/20 4FT R4 277 EZB SCT LP835 F1/24 C110	INTEGRAL	60	277	

- Introduction
- Lighting Depth
 - Main Lobby
 - Open Office
 - Introduction/Location
 - Design Criteria
 - Final Design
 - Design Analysis
 - Ceremonial Courtroom
- Electrical Depth
- Mechanical Breadth
- Acoustical Breadth and MAE Depth
- Conclusion

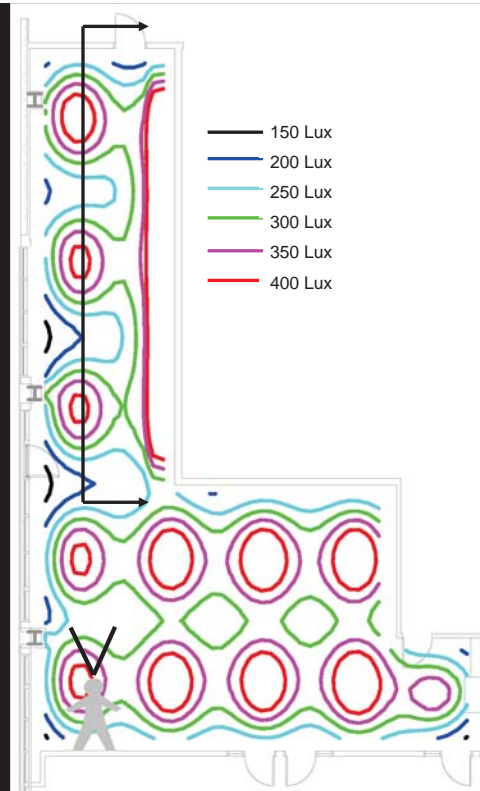

Target Vs. Design Illuminance

	Eh (lux)	Height Eh	Avg:Min	Notes
Target	300	2'6"	1.5:1	
Design	319	2'6"	2.33:1	Grid size: 1'-0" X 1'-0"

- Introduction
- Lighting Depth
- Electrical Depth
- Mechanical Breadth
 - Data Sources
 - Analysis
 - Conclusion
- Acoustical Breadth and MAE Depth
- Conclusion

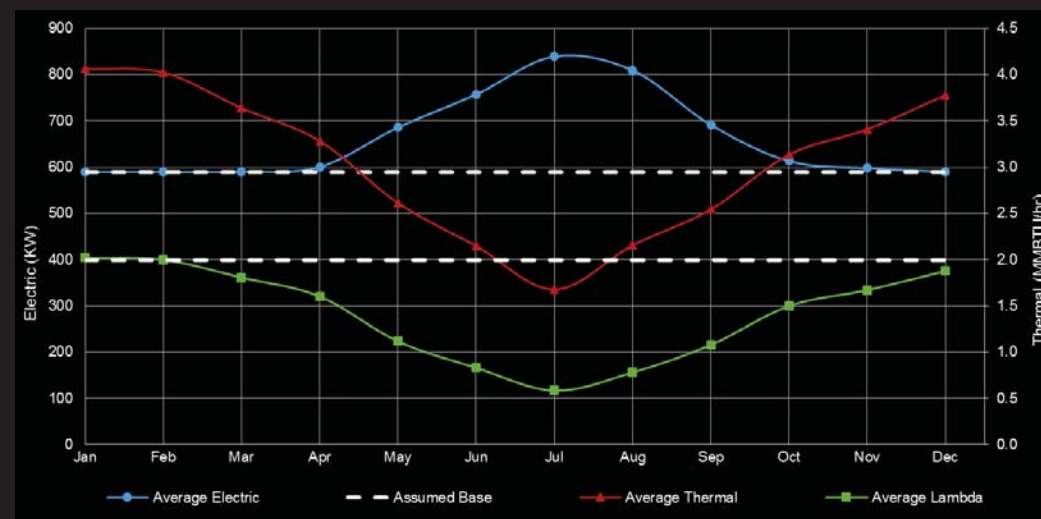

Thermal and Electrical Base Loads

Summer Average (June, July, August)		Winter Average (December, January, February)	
Thermal (MMBTU/hr)	1.99	Electric (kW)	590

λ_D
Total
1.34