



The American Indian Housing Initiative *Completed Projects*



2004: **Technology Center**
Northern Cheyenne Reservation, Montana



2004: **Sweat Lodge**
Northern Cheyenne Reservation, Montana



2003: **Demonstration Home**
Northern Cheyenne Reservation, Montana



2002: **Adult Education Center**
Northern Cheyenne Reservation, Montana



2001: **Bear Quiver Residence**
Northern Cheyenne Reservation, Montana



2000: **Fast Wolf Residence**
Pine Ridge Reservation, South Dakota



1999: **White Residence**
Crow Reservation, Montana

2004:

Technology Center

Northern Cheyenne Reservation, Montana

Size: 4800 SF

Cost: \$140,000

Day Lighting with Polycarbonate Glazing system provides an energy efficient solution for day lighting

Cellulose Insulation
Insulation made from recycled newspaper is safe & effective, and recycles a waste product.

Wheat Board
Finish surfaces covered with PrimeBoard, a panel product made from straw.

Radiant Floor Heating
used to reduce concrete required in foundation

Re-Use of Existing Foundation and Frame
Re-using the existing steel frame and foundation saves materials, money, & energy.

Structurally Insulated Panel roof construction increases energy efficiency and reduces material use

Reflective Surfaces
Maximize use of daylight

Low VOC Paint
Minimizes harmful and unhealthy air contaminants

Straw Bale Walls
Straw bales are stacked and strapped together to form sturdy, insulating walls.

Original structure and frame

New structure, original frame

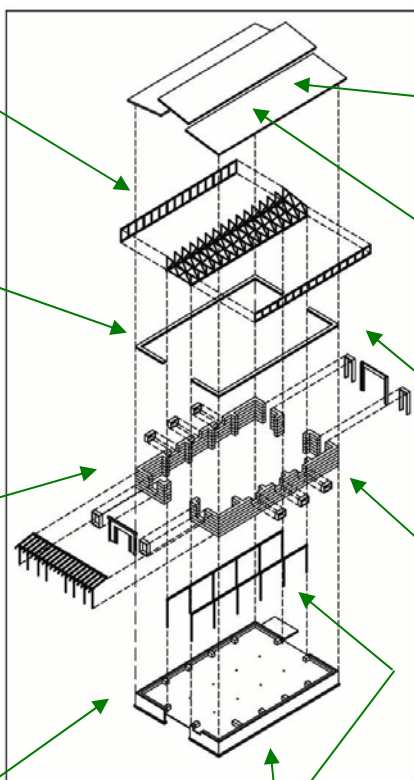

2004:

Sweat Lodge

Northern Cheyenne Reservation, Montana

Size: 20' outside, 18' inside diameter

Cost: \$3500



2003:

Demonstration Home

Northern Cheyenne Reservation, Montana

Size: 1100 SF

Cost: \$51,000

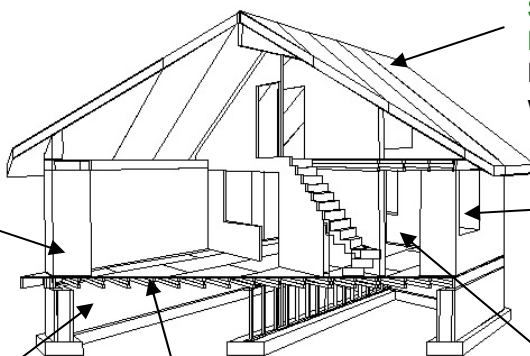

Structural Insulated (SIP) Roof Panels

High insulation value, minimize wood framing

Energy Efficient Windows

Reduce heating costs

Strawbale Walls

Durable and highly insulating, easy to construct

Insulated Concrete Forms

Reduces concrete needed in foundation, save energy

Radiant Floor Heating

Energy efficient and comfortable

Healthy Paint and Finish Materials

Reduce health risks from toxic materials

2002:

Adult Education Center

Northern Cheyenne Reservation

Lame Deer, Montana

Size: 1600 SF

Cost: \$102,000



2001:

Bear Quiver Residence
Northern Cheyenne

Reservation

Busby, Montana

Size: 2100 SF

Cost: \$65,000



2000:

Fast Wolf Residence

Pine Ridge Reservation

Red Shirt, South Dakota

Size: 1600 SF

Cost: \$45,000



1999:

White Residence

Crow Reservation

Crow Agency, Montana

Size: 1100 SF

Cost: \$58,000

