

CASINO GOLD

EAST COAST, USA



9/9/2013

Lighting Proposal Memo

Brad Robertson

Penn State Architectural Engineering – Lighting/Electrical Option

Faculty Consultant – Shawn Good

Lighting Proposal Memo

TECHNICAL REPORT 1, PART 1

EXECUTIVE SUMMARY

This report indicates the four spaces that will be studied for Senior Thesis. Once approved, these spaces will be analyzed and the lighting redesigned. A large workspace, special purpose space, circulation space, and an outdoor space have been chosen.

Workspace: Poker Room

Special Purpose: Player's Lounge

Circulation: Pre-Function Space

Outdoor: Plaza

THREE SCHEMATIC DESIGN CONCEPTS

Three different design concepts will be produced for the outdoor plaza.

PSYCHOLOGICAL IMPRESSION

A lighting solution that provides an impression of relaxation will be produced for the Player's Lounge.

Table of Contents

SUMMARY 1

POKER ROOM..... 3

PLAYER'S LOUNGE 4

PRE-FUNCTION 5

PLAZA 6

Poker Room

For some it is a form of entertainment, for others it is a source of income. A poker room is about as close to a workspace as a casino will have. Players grind away at these tables for hours on end, often without leaving their seats. A space this heavily used must be visually comfortable so occupants will stick around for the long haul.

TASKS AND ACTIVITIES

Reading, writing, computer use

DIMENSIONS

Approximate length: 102'

Approximate width: 90'

Approximate height: 13'

Area: 9,180 sq. ft.

MATERIALS

Ceiling: Wood, paint

Walls: Paint, wood

Floor: Carpet, tile



Borgataspringpoker2011.blogspot.com

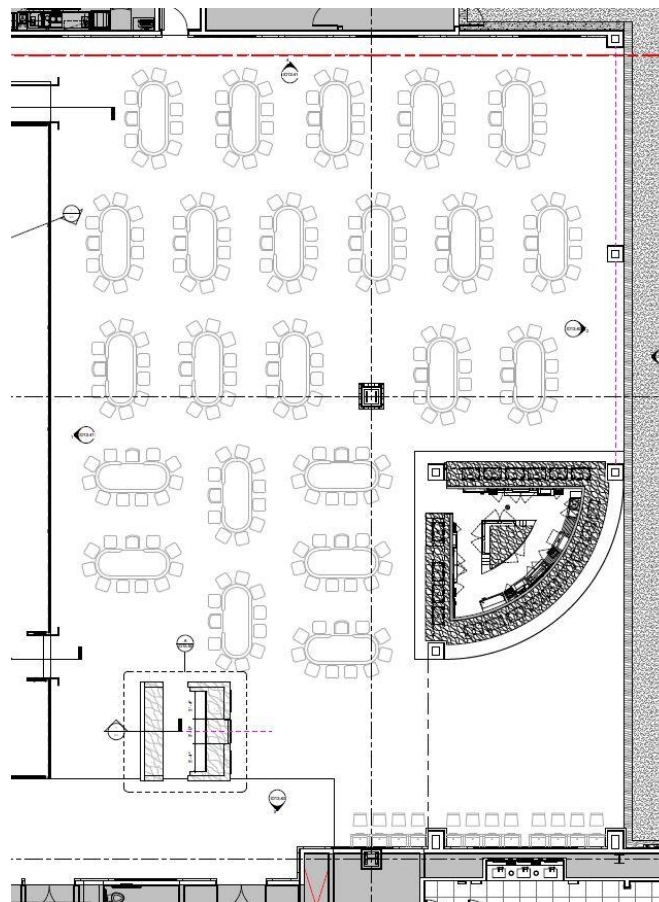

Player's Lounge

After a heart pumping gaming session it is necessary to have a space that allows the mind to unwind and the body to relax. A well designed player's lounge can do just that. This lounge allows 45 guests to choose between comfortable couches, chairs, or a place at the bar.

TASKS AND ACTIVITIES

Reading, dining, socializing, mixing drinks

DIMENSIONS

Approximate length: 46'

Approximate width: 44'

Approximate height: 13'

Area: 2,024 sq. ft.

MATERIALS

Ceiling: Wood, paint

Walls: Wood panels, glass, paint

Floor: Carpet, tile

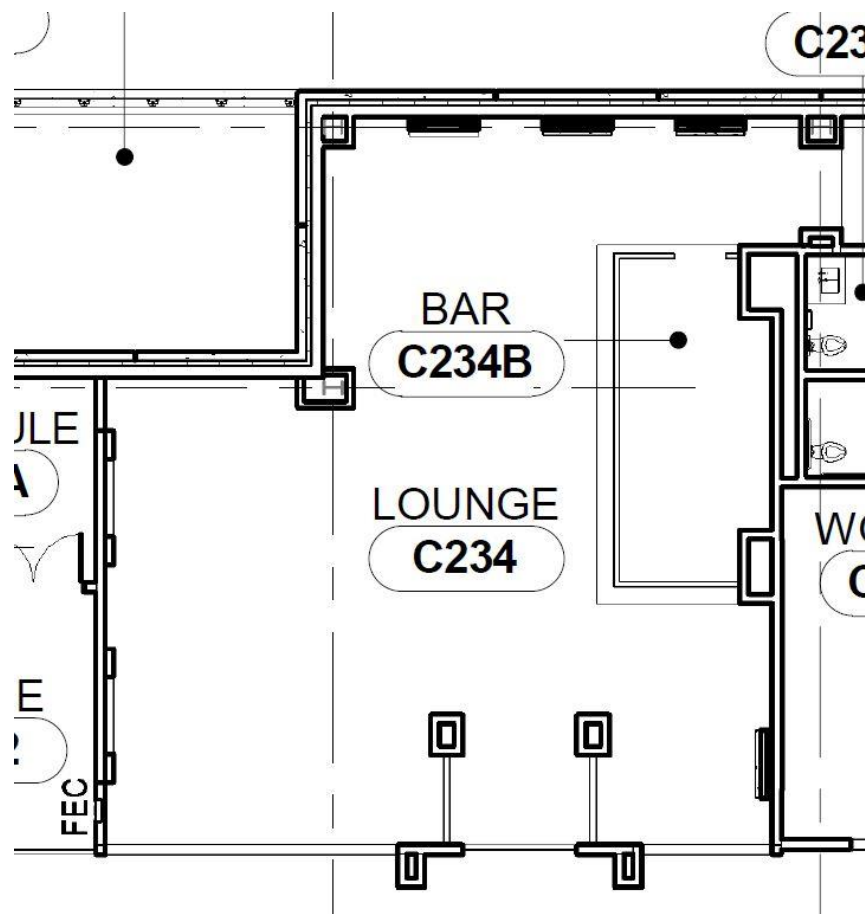

Pre-Function

Before a conference, lecture, or group dinner begins, guests congregate around the multi-purpose room entryways to be the first through the door. A properly designed pre-function space provides a comfortable holding area for these eager guests. Even though it doubles as a circulation space, it must live up to the high design standards which exist in the rest of the casino.

TASKS AND ACTIVITIES

Reading, writing, possible display space

DIMENSIONS

Approximate length: 55'

Approximate width: 20'

Approximate height: 13'

Area: 1,100 sq. ft.

MATERIALS

Ceiling: Paint, wood

Walls: Paint, wood

Floor: Carpet

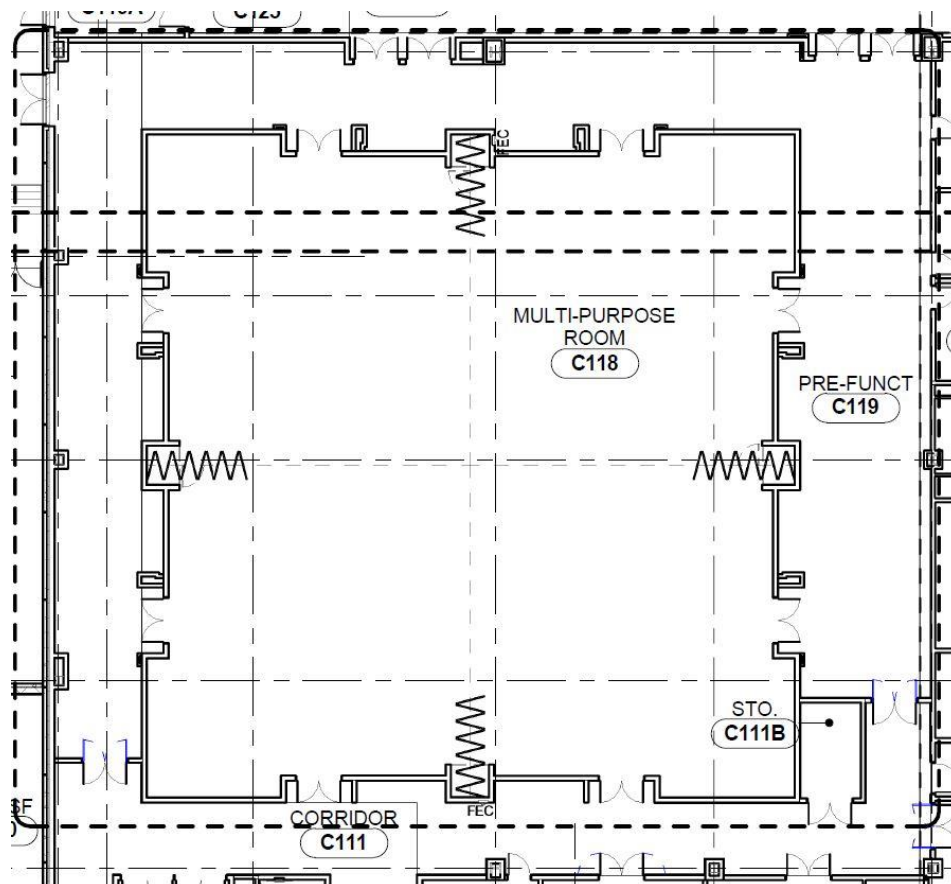

Plaza

First impressions are a key factor in successful relationships, businesses, and especially casinos. The outdoor plaza serves as a link between ground level transportation and the casino. It can also be a place to relax, wait for friends, or do some great people watching.

TASKS AND ACTIVITIES

Sitting, walking, safety

DIMENSIONS

Approximate length: 80'

Approximate width: 220'

Area: 17,600 sq. ft.

MATERIALS:

Glass, stone, concrete, landscaping

